

Guide to the Mercer Museum

The Mercer Museum is a history museum of everyday life in America during the 18th and 19th centuries. Henry Mercer (1856-1930) gathered the collection and completed construction of the Museum in 1916. The collection of 40,000 objects documents the lives and tasks of early Americans through the tools that met their needs and wants prior to the Industrial Revolution, or before about 1850.

Visitors can choose their own paths through the Museum. Most of the 55 exhibit rooms and alcoves display the tools or products of an early American craft, trade or occupation. Other rooms show categories of objects such as lighting devices or architectural hardware.

The Spruance Library of the Bucks County Historical Society, located on Level Three, houses an extensive research collection of Bucks County history and genealogy, as well as the history of trades, crafts and early industries.

The Library is open to all Museum visitors.

General Information

No food or drink in the Museum. Beverage vending machine is located in coat room.

No smoking.

Please **Do Not Touch** any of the objects.

Photography: The use of hand-held cameras and electronic flash is permitted; no tripods or large format cameras, please. Video cameras are allowed for personal use only. Publication of visitor-taken photographs of Museum objects or exhibits is prohibited without the express written consent of the Museum.

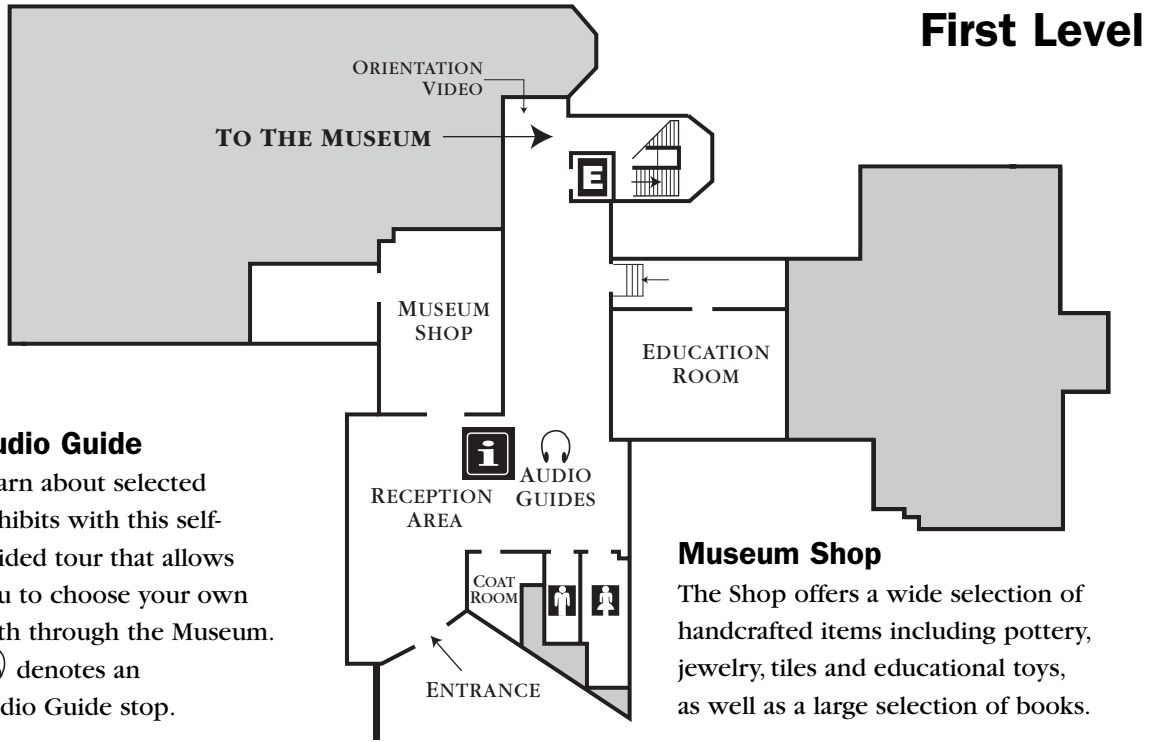

Audio Guide

Learn about selected exhibits with this self-guided tour that allows you to choose your own path through the Museum. denotes an Audio Guide stop.

Museum Shop

The Shop offers a wide selection of handcrafted items including pottery, jewelry, tiles and educational toys, as well as a large selection of books.

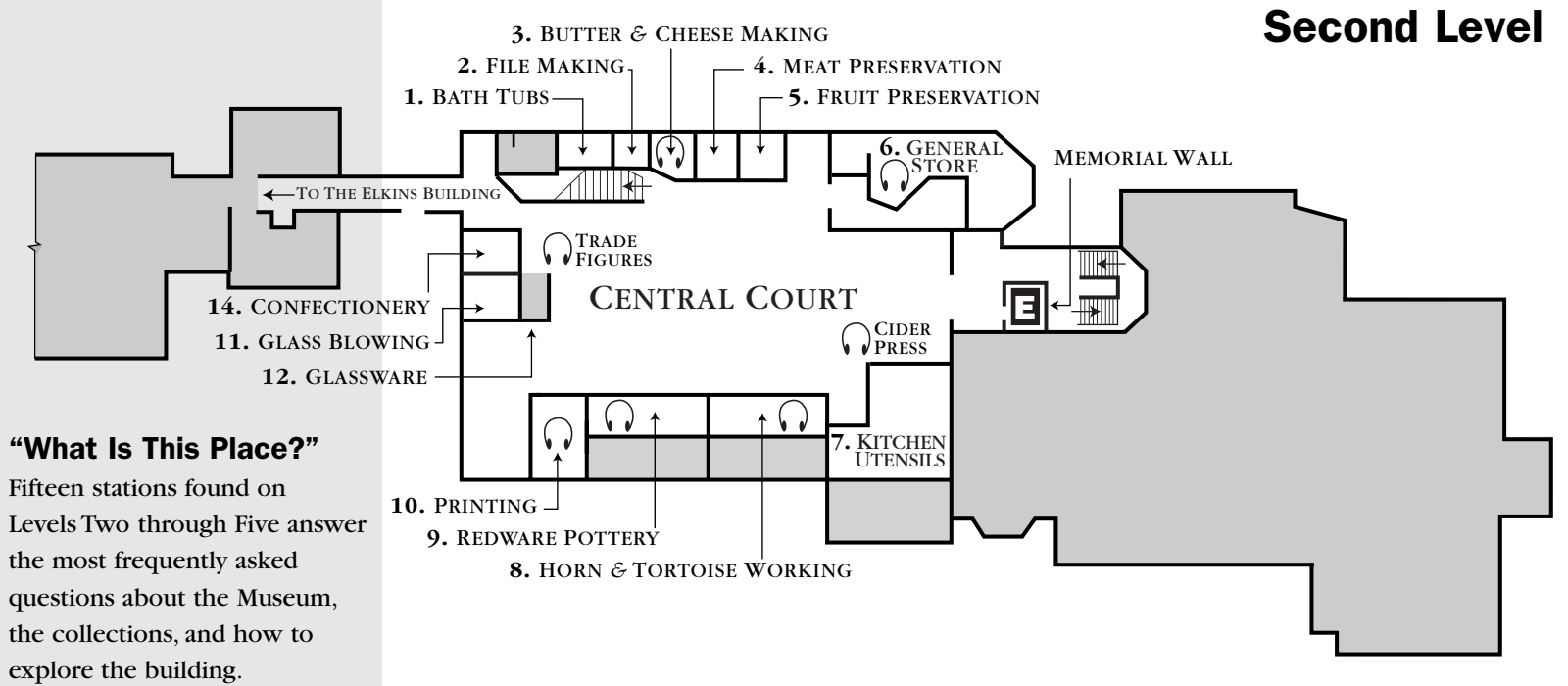

“What Is This Place?”

Fifteen stations found on Levels Two through Five answer the most frequently asked questions about the Museum, the collections, and how to explore the building.

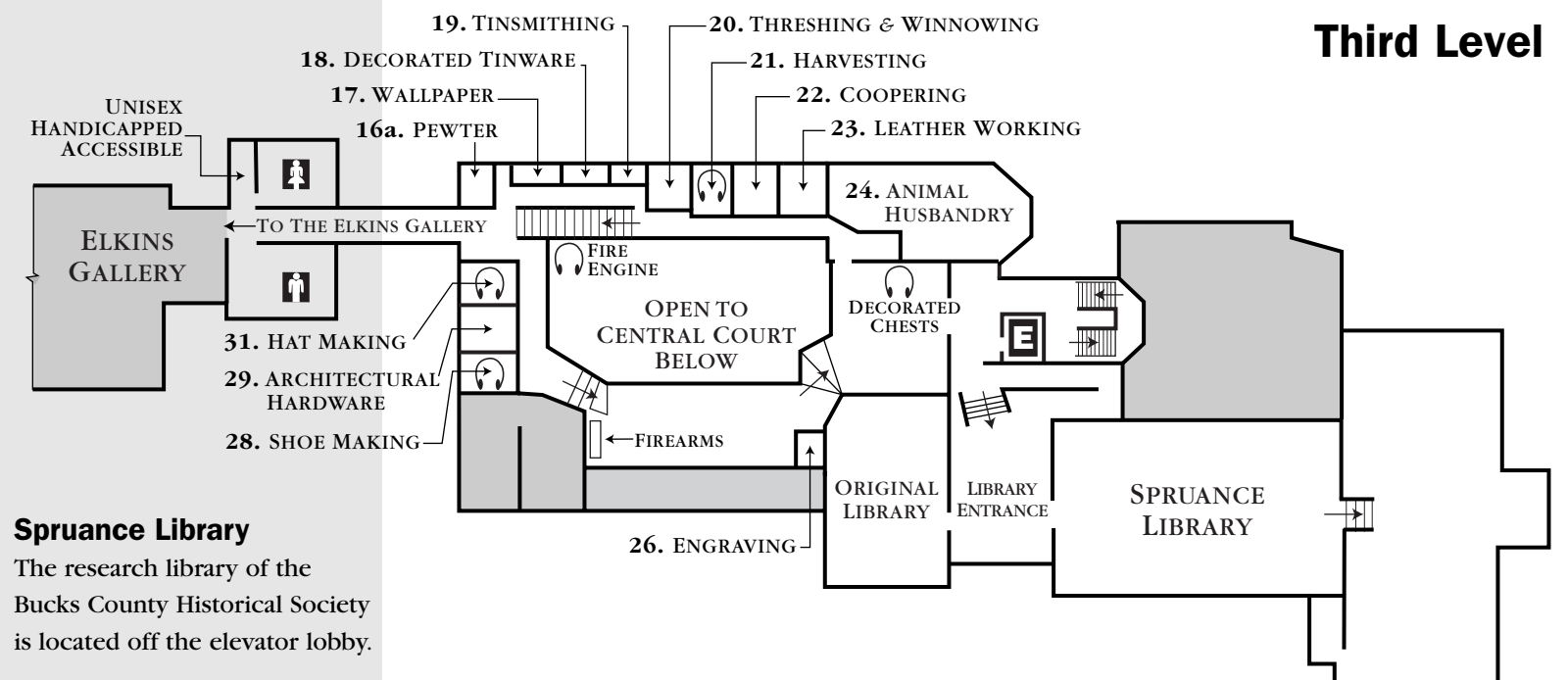

Spruance Library

The research library of the Bucks County Historical Society is located off the elevator lobby.

Mercer Museum

Guide to the

Fourth Level

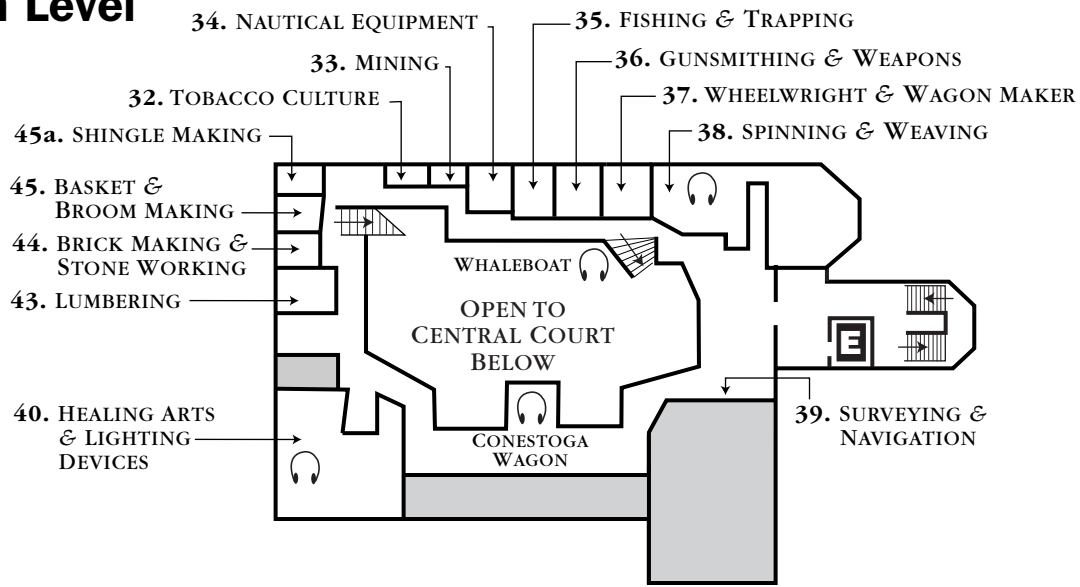

Fifth Level

Betz and Owl Terrace Galleries

These galleries present temporary exhibits related to the Historical Society's three themes: Everyday Life in Pre-Industrial America; Bucks County History and Culture; and the Life of Henry Mercer.

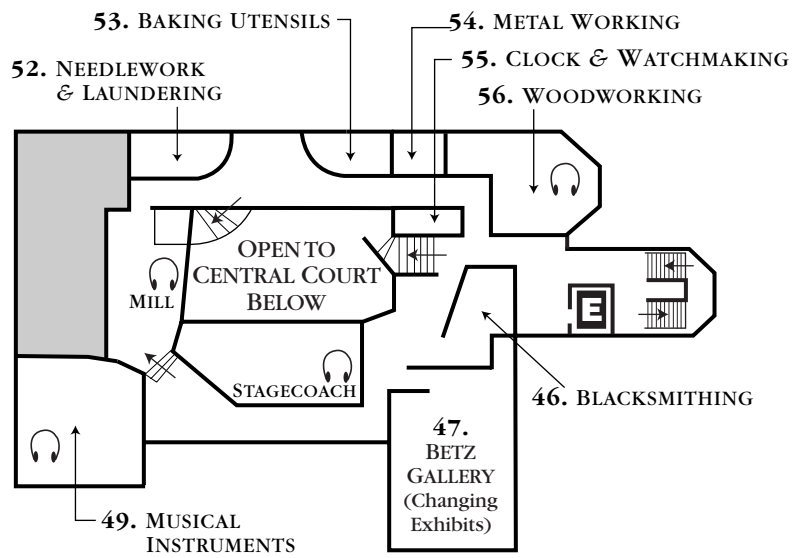

Sixth Level

66. Columbus Gallery

"Early Encounters: The Lenape and the European in the Delaware Valley"

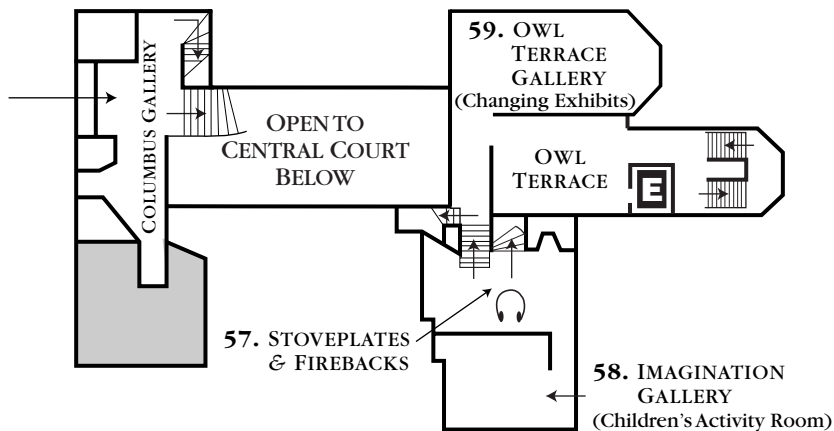

Roof Galleries

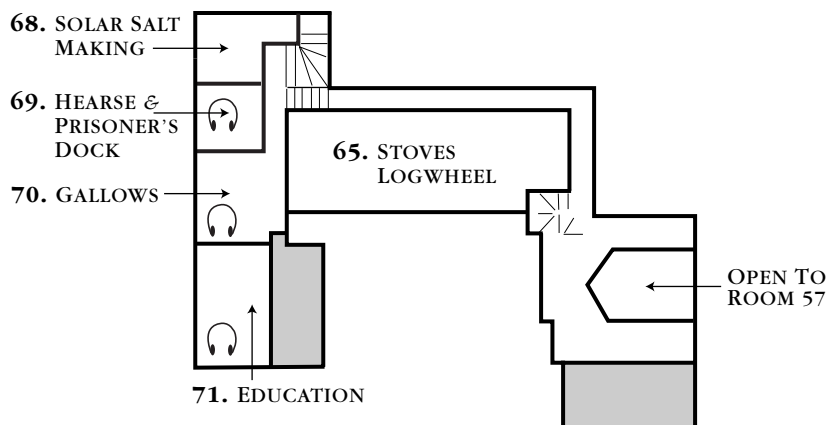

The Bucks County
Historical Society

- Mercer Museum
- Spruance Library
- Fonthill Museum

84 South Pine Street
Doylestown, PA 18901
(215) 345-0210

www.mercermuseum.org